

Setscrew flat on bottom of .750" dia. opposite gas port hole

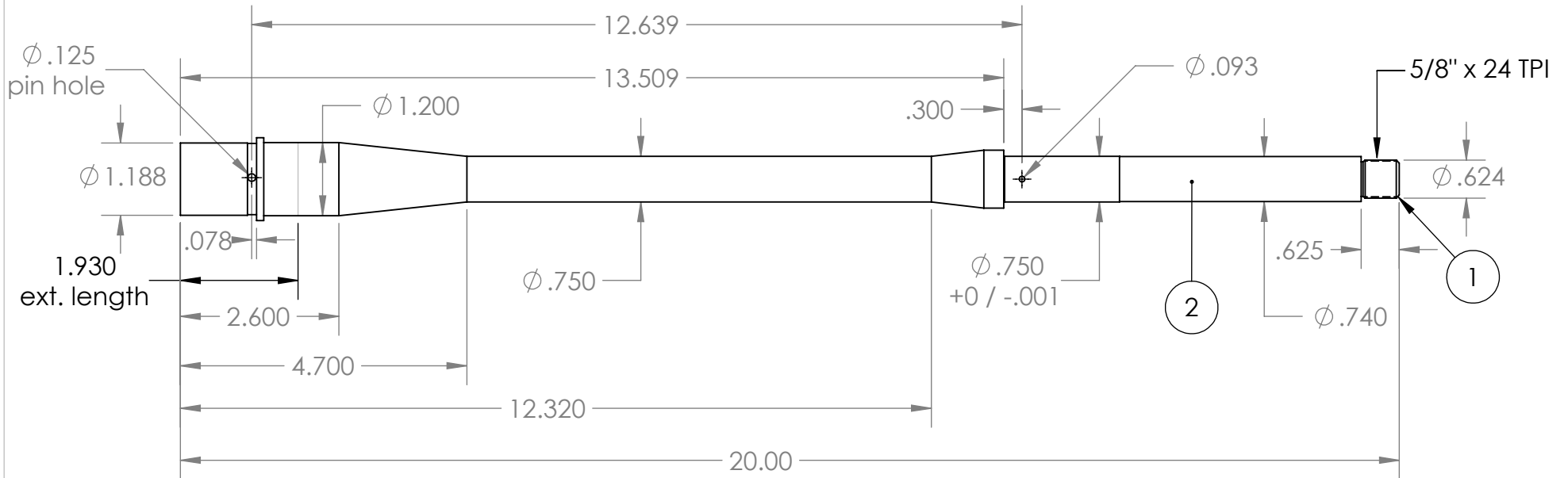
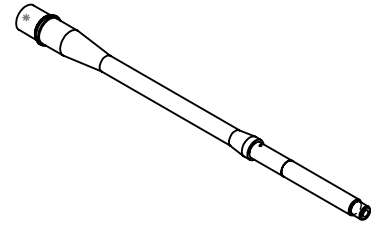
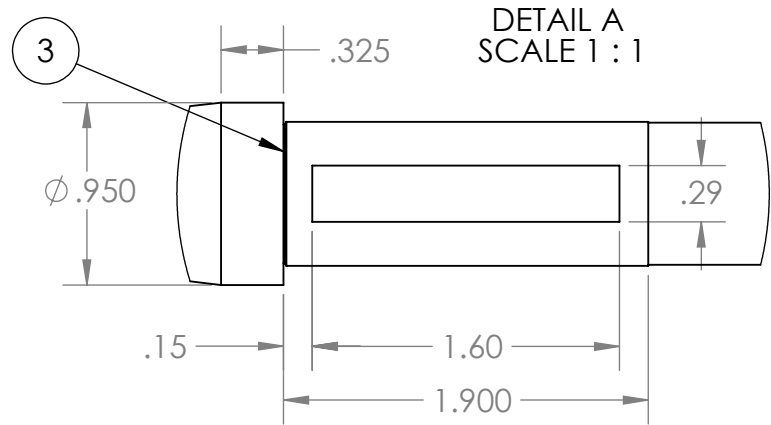
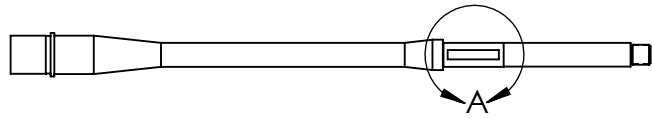

Note 1. .050" x .050" chamfer

Note 2. Engrave Lilja, cartridge, twist

Note 3. Undercut shoulder

Note 4. 11° target crown

Note 5. Haas lathe program
000306

PROPRIETARY AND CONFIDENTIAL
THE INFORMATION CONTAINED IN THIS DRAWING IS THE SOLE PROPERTY OF Lilja Precision Rifle Barrels, Inc. ANY REPRODUCTION IN PART OR AS A WHOLE WITHOUT THE WRITTEN PERMISSION OF Lilja Precision Rifle Barrels, Inc. IS PROHIBITED.

UNLESS OTHERWISE SPECIFIED:

DIMENSIONS ARE IN INCHES
TOLERANCES:
FRACTIONAL ±
ANGULAR: MACH ± BEND ±
TWO PLACE DECIMAL ± .010
THREE PLACE DECIMAL ± .005

INTERPRET GEOMETRIC TOLERANCING PER:

MATERIAL

FINISH

DO NOT SCALE DRAWING

NAME DATE

DRAWN DL 18APR12

CHECKED

ENG APPR.

MFG APPR.

Q.A.

COMMENTS:

weight in .308 Win:

2.56 pounds

Lilja Precision Rifle Barrels, Inc.
P.O.Box 372, Plains, MT 59859
www.riflebarrels.com
406-826-3084

SIZE	DWG. NO.	REV
A	ar10_740	
SCALE: 1:4	WEIGHT:	SHEET 1 OF 1